

ITEM NO. _____
 PROJECT _____
 LOCATION _____
 DATE _____ QTY. _____



Reversible door swing on all models

BSM/BSL-252A



BSM & BSL SERIES

Bottom Mounted Solid Door Reach-Ins

REFRIGERATORS

- BSM-124A
- BSM-252A
- BSM-380A

FREEZERS

- BSL-124A
- BSL-252A
- BSL-380A

Energy Star certification applies to BSM-380A and BSL-380A only.

FEATURES

STANDARD ELECTRONIC CONTROL

- Digitally displays inside temperature
- Tamper proof control
- Allows user to monitor and adjust temperature set point within normal temperature range
- Visual alarm
- Decreases service time and calls
- Eliminates room thermostat, defrost termination/fan delay control, defrost timer and separate digital thermometer or other temperature indicator

CONSTRUCTION

- Stainless steel exterior on front, sides and doors
- Exterior top, bottom and back are galvanized steel
- Interior liner and door panel are smooth aluminum
- 2" thick walls are foamed-in-place with polyurethane insulation

- 4" diameter casters (Four casters on one- and two-door models and six on three-door models)
- Three adjustable heavy-duty epoxy-coated shelves per door

DOORS

- Self-closing
- Hold open feature
- Heavy-duty pivot hinges
- Centered key locks
- Edge grip handles
- Self-adjusting magnetic gaskets
- Interior incandescent light activated by switch for each door
- Full perimeter, anti-condensate heater wires on freezers
- Standard door swing configuration:
 - BSM/BSL-124A hinged right
 - BSM/BSL-252A left door hinged left, right door hinged right
 - BSM/BSL-380A left door hinged left, middle door hinged left, right door hinged right
- Door width: 27"

REFRIGERATION

- Self-contained bottom mount refrigeration system
- Capillary tube on refrigerators and thermostatic expansion valve on freezers to control refrigerant flow
- Recessed drain line on cabinet back
- Automatic defrost
- Automatic condensate evaporator
- Refrigerant:
 - Refrigerators R-134a
 - Freezers R-404A
- Operating temperature:
 - Refrigerators 38°F (3°C)
 - Freezers -10°F (-23°C)

WARRANTY

- Standard limited four year extended compressor and one year limited parts and labor

OPTIONS

- Extra shelves
- Pan rack

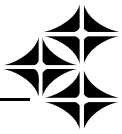

Kool Star®

BSM & BSL SERIES BOTTOM MOUNTED SOLID DOOR REACH-INS

TECHNICAL SPECIFICATIONS

MODEL	DIMENSIONS (in.)			DIMENSIONS (mm)			VOLTS	AMPS	UNIT H.P.	NO. OF DOORS	NO. OF SHELVES	STANDARD SHELF SIZE (in inches)	CAP. CU. FT.	SHIP CU. FT.	SHIP WT. (LB/KG)
	L	D	H*	L	D	H*									
REFRIGERATORS															
BSM-124A	27 1/2	34	82 1/2	699	864	2096	115	4.4	1/5	1	3	28 x 22	24.0	64.0	365/166
BSM-252A	55	34	82 1/2	1348	864	2096	115	6.3	1/4	2	6	28 x 24 1/2	52.0	115.3	545/248
BSM-380A	82 1/2	34	82 1/2	2096	864	2096	115	6.4	1/4	3	9	***	80.0	167.5	750/341
FREEZERS															
BSL-124A	27 1/2	34	82 1/2	699	864	2096	115	9.8	1/2	1	3	28 x 22	24.0	64.0	375/170
BSL-252A	55	34	82 1/2	1348	864	2096	115	13.9	3/4	2	6	28 x 24 1/2	52.0	115.3	660/300
BSL-380A	82 1/2	34	82 1/2	2096	864	2096	208-230**	8.7	1	3	9	***	80.0	167.5	805/366

*Height includes casters. **208-230/60/1 also requires neutral and safety ground wire. ***LH & RH shelf for 3 door models is 28" x 24 1/2", center shelf is 28" x 27 1/2".

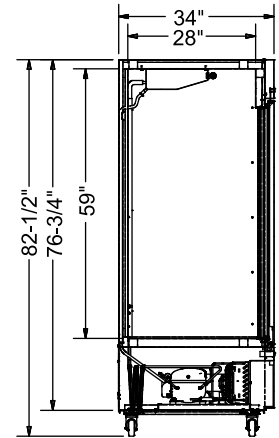
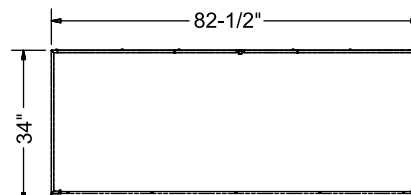
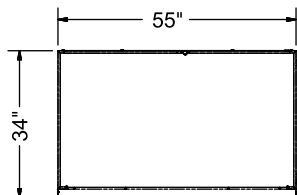
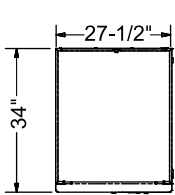

**BSM/BSL-124A
PLAN VIEW**

**BSM/BSL-252A
PLAN VIEW**

**BSM/BSL-380A
PLAN VIEW**

SIDE VIEW

LISTINGS



Energy Star applies to BSL-380A and BSM-380A only.

HOOKUP

All models except BSL-380A: Via plug in, 10 foot long flexible three wire 14/3 cord with molded plug.

BSL-380A: Via plug in, 10 foot long flexible four wire 208-230v 12/4 cord with neutral and ground wires and molded plug.

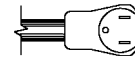

NEMA 5-15P (All refrigerator models and BSL-124A)

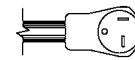

NEMA 5-20P (BSL-252A)

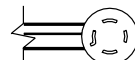

NEMA L14-20P (BSL-380A)

BID SPECIFICATIONS

Item no. BSD-_____A
Provide _____ () Bottom Mounted Solid Door Reach-in(s), Kool Star model no. BSM/BSL-_____.

Reach-in will be equipped with an electronically controlled monitoring system and will feature stainless steel exterior on

front, sides and doors with galvanized steel on exterior top, bottom and back. Door swing will be reversible.

The refrigeration system will be bottom mounted and self-contained. Freezers will use R-404A refrigerant, refrigerators will use R-134a. The operating temperature will be -10°F for freez-

ers (-23°C) and 38°F (3°C) for refrigerators.

Reach-in to have standard limited 4 year extended compressor warranty and one year limited parts and labor warranty. Reach-in to be UL and C-UL listed and UL EPH classified. BSL-380A and BSM-380A models are Energy Star certified.

NOTE: Cabinet designed for optimum performance in air-conditioned area at 75°F ambient and 55% relative humidity. All specifications subject to change without notice.



21720 South Wilmington Ave. • Suite 309 • Long Beach, CA 90810
P: 888-478-8600 • F: 310-513-8156 • www.koolstar.com



1318-2/10-1.5m
©Kool Star division of Standex International, Inc. All rights reserved. Printed in U.S.A.